

Connecting Windows 8 to “CityU Alumni” wireless network

- a) Select the cog icon “Settings”

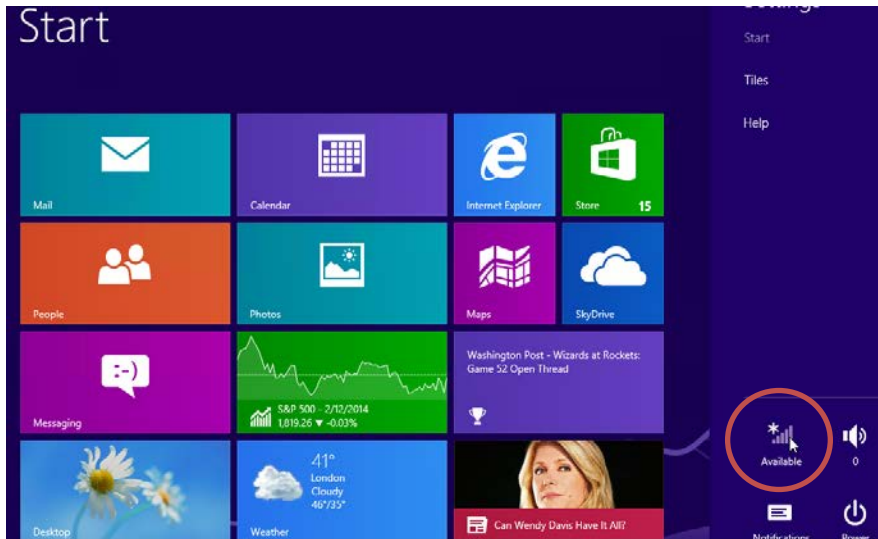

- b) Click the "Wireless Network" icon to list the available wireless networks in range



- c) Select "CityU Alumni" and then click the "Connect" button to establish connection.

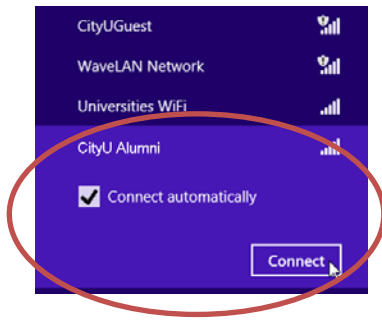

Enter your **EID**, **network connection password** and press the “OK” button to login.

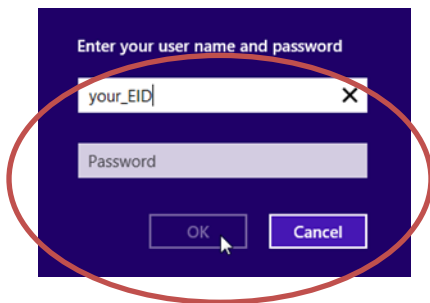

A security alert box may be displayed. Click the “**Connect**” button to continue.

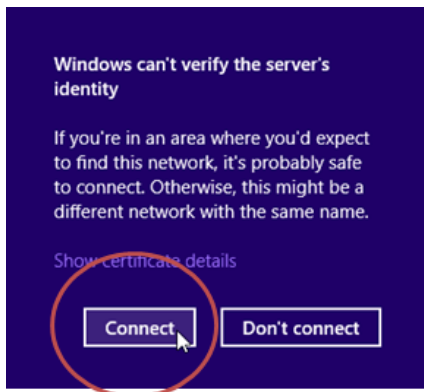

d) You may enjoy free Internet access upon successful logon.